

# STUDIO APARTMENT

# ONE BED



**AREA = 380 SQ.FT**  
**2 x 8 = 16 Nos**

# ONE BED



ENT

**AREA = 585-625 SQ.FT**  
**37 x 8 = 296 Nos**

# ONE BED

## Type-B



ENT.

**AREA = 480-525 SQ.FT**  
**14 x 8 = 112 Nos**

BALCONY  
4'-6" WIDE

Type-C

BATH  
7'-3"X6'-0"

BED  
15'-8"X11'-0"

LOUNGE  
14'-0"X12'-0"

KITCHEN  
9'-0"X12'-0"

ENT.

AREA = 595 SQ.FT  
1 x 8 = 8 Nos

ONE  
BED



## Type-D



ENT

AREA = 870-1020 SQ.FT

5 x 8 = 40 Nos

# ONE BED

## Type-A



# THREE BEDS

AREA = 1570 - 1930 SQ.FT  
10 x 8 = 80 Nos

## Type-B



# THREE BEDS

AREA = 1550 SQ.FT  
1 x 8 = 8 Nos

# THREE BEDS

Type-C



AREA = 1970 SQ.FT  
1 x 8 = 8 Nos



Type-D

THREE  
BEDS



AREA = 1840 SQ.FT  
1 x 8 = 8 Nos

# TWO BEDS



**AREA = 1050-1200 SQ.FT**  
**4 x 8 = 32 Nos**

# TWO BEDS



**AREA = 1200 SQ.FT**  
**14 x 8 = 8 Nos**

## Type-C



# TWO BEDS

AREA = 1080 SQ.FT  
1 x 8 = 8 Nos



**Type-D**

**TWO  
BEDS**

Type-E

# TWO BEDS

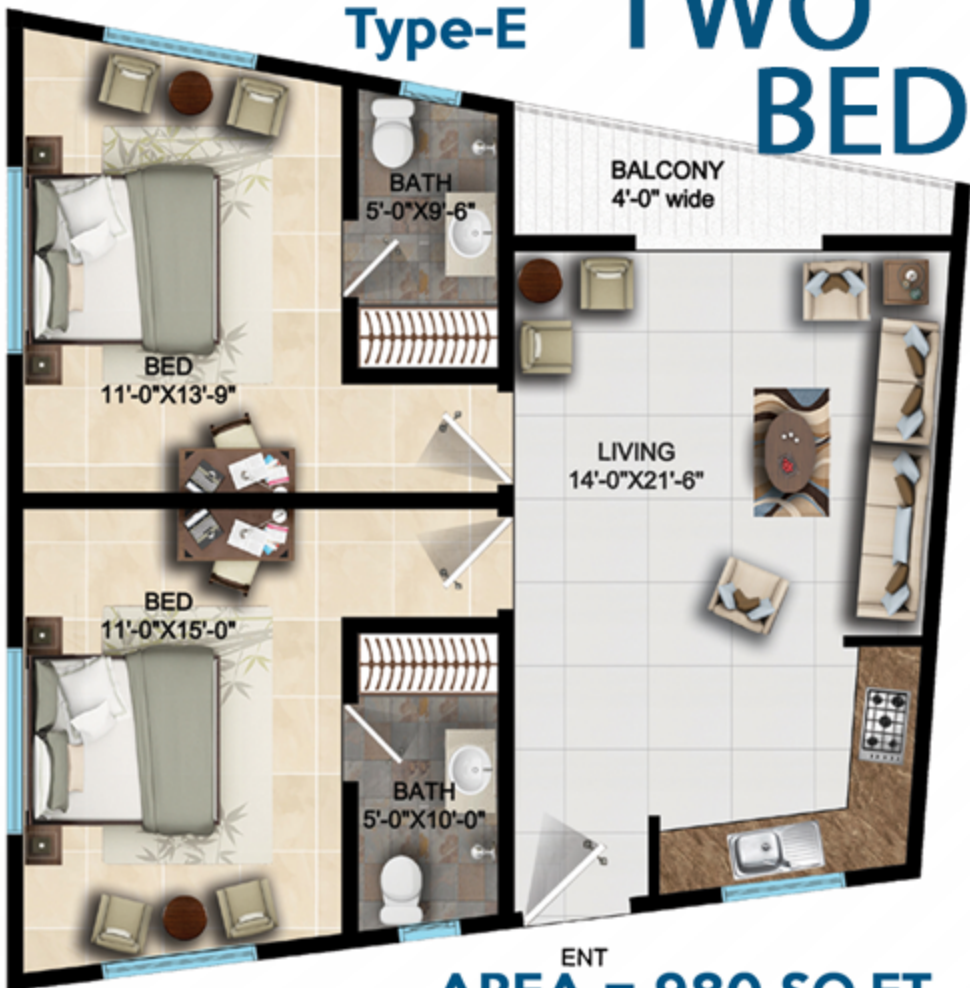

**AREA = 980 SQ.FT**  
**1 x 8 = 8 Nos**

## Type-F



# TWO BEDS

**AREA = 1025 SQ.FT**  
**1 x 8 = 8 Nos**

Type-G



TWO  
BEDS

ENT

AREA = 1200-1500 SQ.FT  
16 x 8 = 128 Nos



Type-H

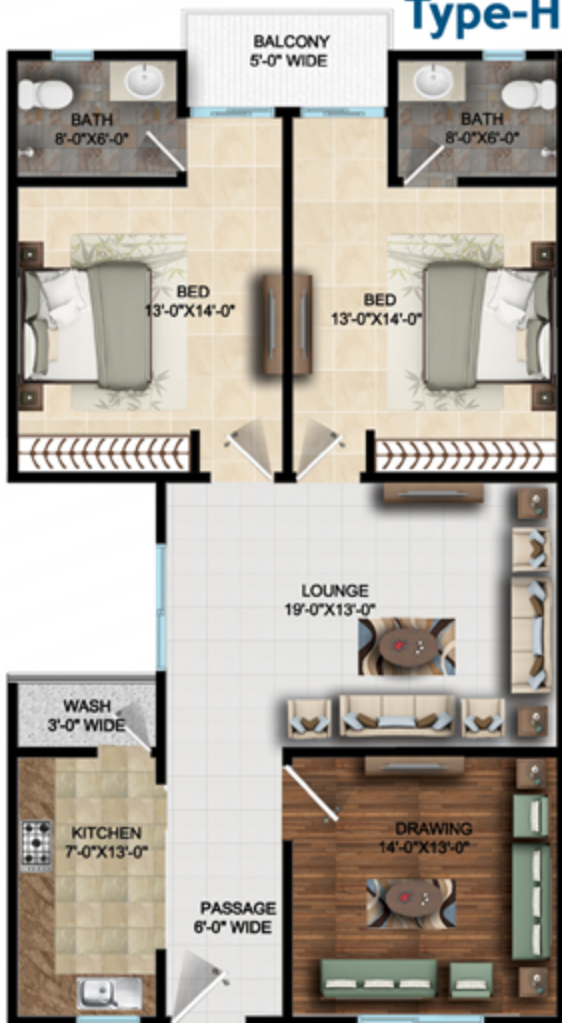

TWO  
BEDS

AREA = 1050-1250 SQ.FT  
7 x 8 = 56 Nos



# TWO BEDS

Type-1



**AREA = 1400 SQ.FT**  
**1 x 8 = 8 Nos**

# Type-J

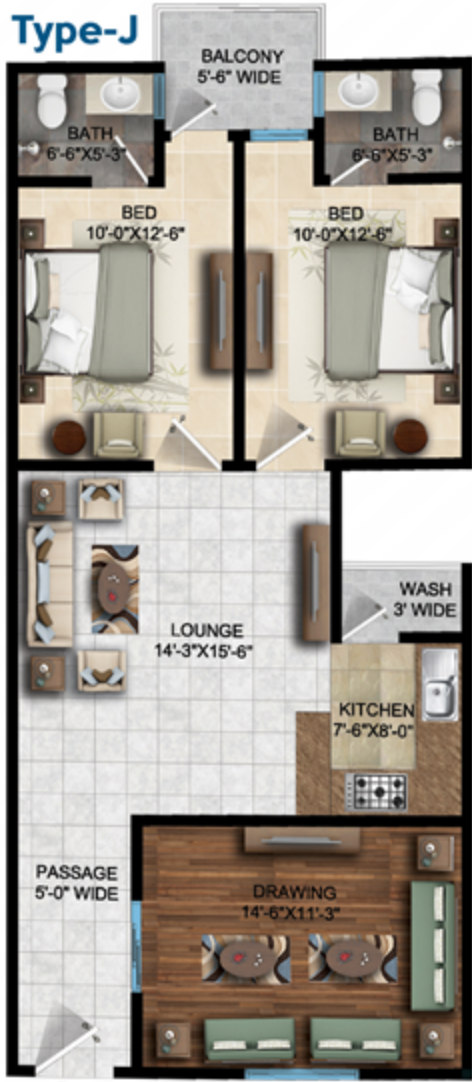

# TWO BEDS

**AREA = 1080 SQ.FT**  
**2 x 8 = 16 Nos**

# Type-K



# TWO BEDS

AREA = 1400 SQ.FT  
1 x 8 = 8 Nos

## Type-L



**AREA = 1250 SQ.FT**  
**1 X 8 = 8 Nos**

# TWO BEDS

# Type-M



# TWO BEDS

AREA = 1350 SQ.FT  
1 x 8 = 8 Nos



**Type-N**

**TWO  
BEDS**

ENT

**AREA = 1400 SQ.FT**  
**1 x 8 = 8 Nos**